

DRAINAGE & GRADING PLAN - CROSSINGS #1 & #2
SCALE: 1" = 30'

- LEGEND:**
- PROPERTY LINE
 - SS SANITARY SEWER
 - 6" WL WATERLINE
 - EX. STORM SEWER
 - PROP. STORM SEWER
 - EDGE OF PAVEMENT
 - WM WATER METER
 - F.H. FIRE HYDRANT
 - SM SAN. MANHOLE
 - 1000 EXISTING CONTOUR
 - 1000 PROPOSED CONTOUR
 - X 90.9 SPOT GRADE
- ABBREVIATIONS:**
- D.B. = DEED BOOK
 - EX. = EXISTING
 - FH = FIRE HYDRANT
 - HDPE = HIGH-DENSITY POLYETHYLENE (PIPE)
 - INV. = INVERT
 - L.F. = LINEAR FEET
 - MH = MANHOLE
 - NO. = NUMBER
 - P.B. = PLAT BOOK
 - PG. = PAGE
 - PROP. = PROPOSED
 - RD. = ROAD
 - RAW = RIGHT OF WAY
 - SS = SANITARY SEWER - GRAVITY
 - SS-FM = SANITARY SEWER - FORCE MAIN
 - ST = STORM
 - TYP. = TYPICAL
 - WM = WATER METER

OWNER'S STATEMENT

THE OWNER IS AWARE OF THE DESIGN REQUIREMENTS IMPOSED BY THE PLAN AND OTHER APPLICABLE TOWN CODES AND SHALL FURTHER CERTIFY THAT THE OWNER AGREES TO COMPLY WITH THESE REQUIREMENTS, UNLESS MODIFIED IN ACCORDANCE WITH THE TOWN CODE [Subdivision Ordinance Section - (b)]

OWNER/DEVELOPER REPRESENTATIVE _____ DATE _____

OWNER'S RLD STATEMENT

I _____ (CERT/REG NO./PE _____) AS THE INDIVIDUAL IN CHARGE OF AND RESPONSIBLE FOR LAND DISTURBING (RLD) ACTIVITIES ASSOCIATED WITH THE EROSION AND SEDIMENT CONTROL PLAN. I AGREE TO NOTIFY THE TOWN OF BLACKSBURG IN WRITING SHOULD I TRANSFER THIS RESPONSIBILITY TO ANOTHER CERTIFIED INDIVIDUAL BEFORE THE COMPLETION OF THIS PROJECT AND THE RELEASE OF THE EROSION AND SEDIMENT CONTROL BOND.

OWNER/DEVELOPER REPRESENTATIVE _____ DATE _____

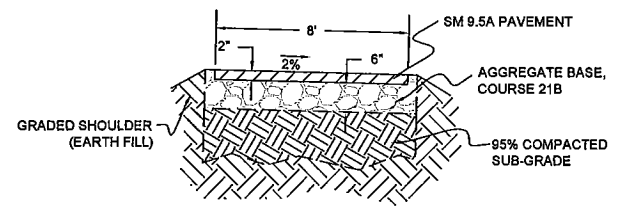

TYPICAL SECTION: ASPHALT PATH
NOT TO SCALE

LEGEND: EROSION AND SEDIMENT CONTROL

NO.*	TITLE	KEY
3.05	SILT FENCE	SF
3.08	CULVERT INLET PROTECTION	CIP
3.18	OUTLET PROTECTION	OP
3.20	ROCK CHECK DAM	CD
3.29	SURFACE ROUGHENING	SR
3.32	PERMANENT SEEDING	PS
3.35	MULCHING	MU
3.36	SOIL STABILIZATION: BLANKET OR MATTING	B/M

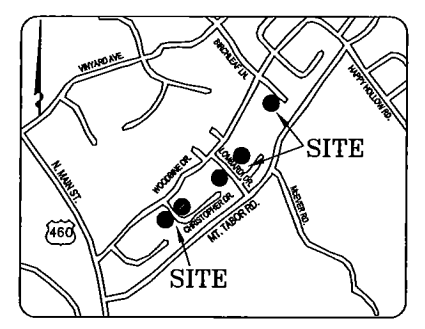

VICINITY MAP
SCALE: 1" = 1,000'

GENERAL NOTES

1. OWNER: WOODBINE HOME OWNER'S ASSOCIATION (HOA). CONTACT AND HOA BOARD MEMBER ARIC BOP: 1-540-818-3677.
 2. THE INTENT OF THIS PLAN IS TO ACCOMMODATE FOR THE CONVEYANCE OF STORMWATER FLOWS AT LOCATIONS WHERE THESE FLOWS CURRENTLY CROSS THE 8' WIDE ASPHALT PATH. THIS IS PROVIDED WITH THE ADDITION OF CULVERTS AT CROSSINGS 1, 2 AND 3. ALSO, GRADING IS PROVIDED AT CROSSING 4 TO ASSIST IN ENCOURAGING FLOWS AWAY FROM THE STRUCTURE AT 2005 BIRCHLEAF LANE. AND A PORTION OF PATH IS RELOCATED WEST OF LOMBARDI DRIVE. THESE IMPROVEMENTS ARE INTENDED ONLY TO PROVIDE A MORE DESIRABLE PASSAGE OF FLOWS FOR THE MORE FREQUENT RUNOFF EVENTS (< 2-YEAR) TO IMPROVE THE SITUATION THAT CURRENTLY EXISTS IN THAT ONGOING EROSION OF THE ASPHALT PATH OCCURS WHERE FLOWS CROSS AND WATER ACCUMULATES AND TRAVELS ALONG THE PATH ITSELF.
 3. THIS PLAN SHEET IS INTENDED TO BE USED IN CONJUNCTION WITH THE 'WOODBINE BLUE-WAY PATH IMPROVEMENTS DRAINAGE NARRATIVE PREPARED BY THE TOWN OF BLACKSBURG IN JUNE, 2009.
 4. NO FIELD SURVEY WAS PERFORMED. TOPOGRAPHICAL INFORMATION IS BASED ON CONTOURS PROVIDED FROM TOWN OF BLACKSBURG 2005 LIDAR DATA. PLANIMETRICS WERE OBTAINED FROM TOWN OF BLACKSBURG GIS DATA. INFORMATION SHALL BE CONSIDERED APPROXIMATE. PLEASE CONTACT LEE HIXON (540-961-1124) WITH THE TOWN OF BLACKSBURG ENGINEERING AND GIS DEPARTMENT IF DISCREPANCIES ARE DISCOVERED THAT AFFECTS THE PLANS DURING THE COURSE OF CONSTRUCTION.
 5. STORM SEWER PIPE SHALL CONFORM TO VDOT AND TOWN OF BLACKSBURG SPECIFICATIONS. HDPE PIPE SHALL BE SMOOTH INTERIOR WALL.
 6. ALL UTILITIES SHALL BE FIELD VERIFIED FOR LOCATION PRIOR TO EXCAVATION. CONTRACTOR SHALL HAVE ALL UNDERGROUND UTILITIES MARKED IN FIELD. CALL MISS UTILITY: 1-800-552-7001.
 7. CONTRACTOR SHALL COORDINATE WITH THE TOWN OF BLACKSBURG TO OBTAIN ALL NECESSARY PERMITS FOR WORK WITHIN THE PUBLIC RIGHT-OF-WAY. ALL WORK IN PUBLIC RIGHT-OF-WAY EASEMENT SHALL CONFORM TO TOWN OF BLACKSBURG STANDARDS AND SPECIFICATIONS, AND SHALL BE INSPECTED BY THE TOWN OF BLACKSBURG.
 8. A PRECONSTRUCTION MEETING SHALL BE HELD WITH THE TOWN OF BLACKSBURG, CONTRACTOR AND OWNER PRIOR TO CONSTRUCTION.
 9. IT IS THE CONTRACTOR'S RESPONSIBILITY TO MEET COMPLIANCE REQUIREMENTS WITH 55.1-406, et. seq., OF THE CODE OF VIRGINIA, OVERHEAD UTILITIES ACT.
 10. IT IS THE OWNER/DEVELOPER'S RESPONSIBILITY TO OBTAIN ANY ADDITIONAL PERMITS REQUIRED BY ANY OTHER FEDERAL OR STATE AGENCY.
 11. THE PROPERTY DOES NOT LIE WITHIN A H.U.D. 100 YEAR FLOODPLAIN.
 12. THERE ARE NO KNOWN GRAVE STRUCTURES OR OBJECTS MARKING A PLACE OF BURIAL IN THE AREAS SHOWN TO BE DISTURBED ON THIS PLAN.
- EROSION CONTROL NOTES**
13. EROSION CONTROL MEASURES SHALL BE INSTALLED PRIOR TO CLEARING AND GRADING.
 14. EROSION AND CONTROL MEASURES SHALL BE AS DESCRIBED IN THE VIRGINIA EROSION AND SEDIMENT CONTROL HANDBOOK (VESCH).
 15. TEMPORARY SEEDING SHALL BE APPLIED WITHIN 7 DAYS TO DENUDED AREAS DURING CONSTRUCTION THAT WILL NOT BE BROUGHT TO FINAL GRADE FOR A PERIOD OF MORE THAN 30 DAYS. PROVIDE SURFACE ROUGHENING IF THE AREA TO BE SEEDED IS COMPACTED, CRUSTED, OR HARDENED. STRAW MULCHING SHALL BE APPLIED TO FACILITATE STABILIZATION. PERMANENT SEEDING SHALL BE APPLIED TO APPLICABLE AREAS WITHIN SEVEN DAYS AFTER FINAL GRADE IS REACHED.
 16. PERMANENT VEGETATION SHALL NOT BE CONSIDERED ESTABLISHED UNTIL IT IS DETERMINED BY THE PROGRAM ADMINISTRATOR THAT VEGETATION IS MATURE ENOUGH TO SURVIVE AND IS SUFFICIENT TO PREVENT EROSION.
 17. SOIL STOCKPILES SHALL BE STABILIZED. OWNER IS RESPONSIBLE FOR PERMANENT STABILIZATION OF ANY SOILS TRANSPORTED FROM THE SITE.
 18. A SUFFICIENT CONSTRUCTION ENTRANCE AND/OR OTHER PROVISIONS SHALL BE MADE TO MINIMIZE THE TRANSPORT OF SEDIMENT ONTO PUBLIC STREETS VIA CONSTRUCTION VEHICLE/EQUIPMENT INGRESS AND EGRESS. WHEN SEDIMENT IS INCIDENTALLY TRANSPORTED ONTO THE ROAD, THE ROAD SHALL BE CLEANED THOROUGHLY AT THE END OF EACH DAY. WASHING SHALL NOT BE PERMITTED UNTIL AFTER SEDIMENT HAS BEEN SWEEPED OR SHOVELED SO THAT SEDIMENT IS NOT TRANSPORTED DOWN SLOPE.
 19. SILT FENCE TO REMAIN UNTIL GROUND IS STABILIZED.
 20. A CERTIFIED RESPONSIBLE LAND DISTURBER SHALL BE IN CHARGE AND RESPONSIBLE FOR CARRYING OUT THE EROSION CONTROL PLAN.
 21. CONTRACTOR SHALL INSPECT EROSION CONTROL MEASURES AFTER SIGNIFICANT RAINFALL TO ASSURE THE PROPER FUNCTION OF MEASURES HAVE NOT BEEN COMPROMISED. ANY REQUIRED REPAIRS OR CLEANUP OF SEDIMENT THAT HAVE BREACHED CONTROLS SHALL BE PERFORMED IMMEDIATELY.
 22. ROCK CHECK DAMS SHALL REMAIN IN PLACE UNTIL THERE IS GOOD VEGETATIVE COVER ON ALL AREAS DISTURBED.
 23. CONTRACTOR SHALL SCRAPE EXISTING SOD (APPROXIMATELY TOP 5 INCHES) AND STOCKPILE. SOD TO BE WATERED IF STOCKPILED FOR LONGER THAN 24-HOURS BEFORE BEING REPLACED AT FINAL GRADE OVER DISTURBED AREAS. REPLACED SOD SHALL BE STAKED IN PLACE. AREAS THAT CANNOT BE STABILIZED WITH THE STOCK-PILED SOD SHALL BE PROVIDED SOIL STABILIZING BLANKET OR MATTING, PERMANENT SEEDING AND MULCH. USE CHECK DAMS AS SHOWN WHEN REPLACEMENT OF SOD IS NOT FEASIBLE.
 24. CONTRACTOR SHALL REPLACE ANY OF THE EXISTING OUTLET PROTECTION (RIP-RAP) DISTURBED DURING THE COURSE OF IMPLEMENTATION OF THESE PLANS, SPECIFICALLY AT THE OUTFALL OF THE CULVERT CROSSINGS AT CHRISTOPHER DRIVE AND LOMBARDI DRIVE. AT CHRISTOPHER DRIVE CROSSING, EXTEND RIP-RAP TO CROSSING #2.
 25. PROVIDE SILT FENCE BELOW ALL FILLS AND DENUDED AREAS.

APPROVED:

TOWN ENGINEER

TOWN PLANNER

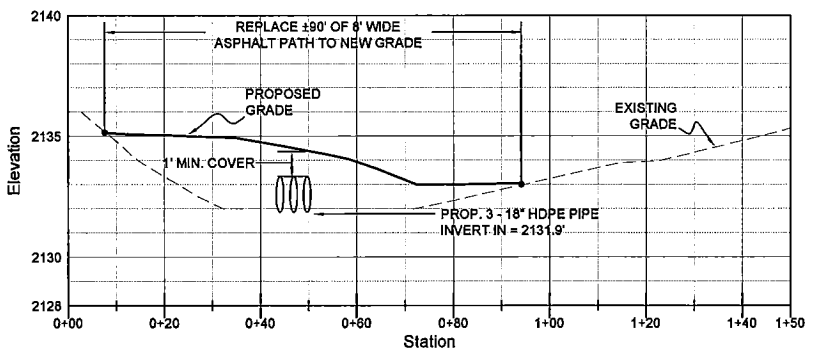

PROFILE VIEW: CENTERLINE PATH - CROSSINGS #1

SCALE
HORIZONTAL: 1" = 20'
VERTICAL: 1" = 4'

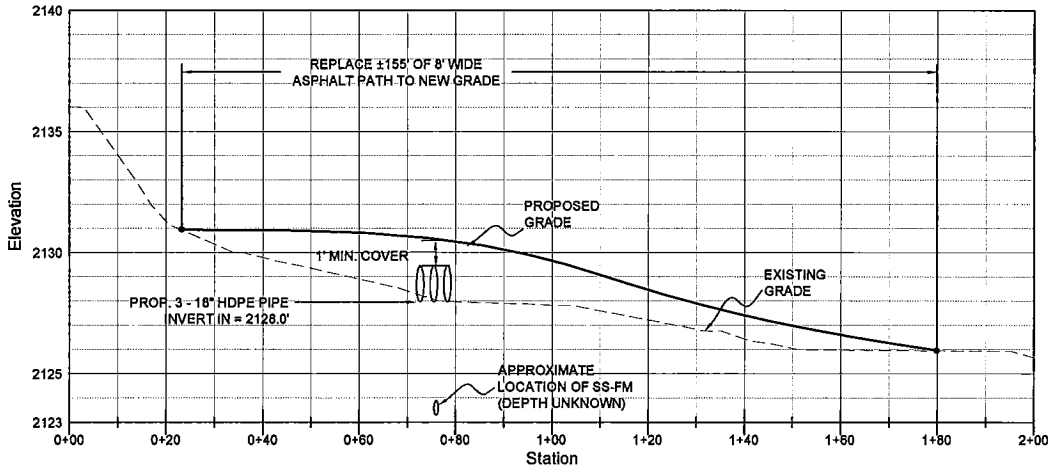

PROFILE VIEW: CENTERLINE PATH - CROSSINGS #2

SCALE
HORIZONTAL: 1" = 20'
VERTICAL: 1" = 4'

TOWN OF
Blacksburg
a special place

Phone (540) 961-1126
Fax (540) 951-0672

300 South Main Street
Blacksburg, Virginia 24060-9003

**WOODBINE BLUE-WAY
PATH IMPROVEMENTS
GRADING & DRAINAGE**

TOWN OF BLACKSBURG, MONTGOMERY COUNTY, VIRGINIA
MT. TABOR MAGISTERIAL DISTRICT

REVISIONS:

NOT FINAL

DESIGNED BY: LFH
DRAWN BY: LFH
CHECKED BY: APS
SCALE: AS SHOWN
DATE: SEPT. 2009

SHEET NUMBER:

1 OF 2

JOB NUMBER: